

**PREMIUM LIST**  
**SCOTTISH DEERHOUND CLUB OF AMERICA**  
**An ASFA Member Club**  
**2022 National Specialty Lure Coursing**  
**Thursday, June 2, 2022**



**Pre-Entries Close ½ hour prior to roll call.**  
**QUALIFY AT THESE 2022 NATIONAL TRIALS.**

**Bavarian Inn Lodge and Conference Center**  
**Coursing Field is located at:**  
**765 Weiss Street**  
**Frankenmuth, Michigan**

**Entry Fees:**  
**\$25 per dog pre entry**  
**\$30 per dog Day of entry**  
**\$20 per dog Certification runs on Tuesday**



Permission has been granted by the American Sighthound Field Association for the holding of this event under The ASFA rules and Regulations.

Audrey Silverstein, Chairperson, ASFA Scheduling Committee

## ENTRIES ARE ACCEPTED THREE WAYS.

- By hard copy mailed to FTS
- By e-mailing scanned entry to FTS, and paying by paypal
- By on-line entry at [www.eriekoevents.com/events](http://www.eriekoevents.com/events) and paying by paypal.
- NOTE All PayPal payments must include \$1.50 per entry fee to cover PP fees.
- Do NOT send entries "signature required".

**NOTE: 2 CLOSING DATES. May 11th to be included in the catalog and May 18<sup>th</sup> absolute latest day to pre enter!**

*The Event Secretary cannot accept conditional, unsigned, incomplete or unpaid entries; please check your completed entry carefully. Entries by e-mail with PP payment will be accepted. PP address [eriek9events@gmail.com](mailto:eriek9events@gmail.com)*

**Entries will not be confirmed unless a legible e-mail address is included.**

**TRIAL HOURS** 6:00 AM – until completion.

### **ROLL CALL & INSPECTION**

Day of Trial Entries close at 6:30am

Substitutions (same owner) until 6:30am

**Rollcall promptly at 7:00 AM – For trial dogs**

**Earlier for Field Committee, if available. 6:30am**

**First course should be on the line by 8:00 AM**

**BEST IN FIELD WILL NOT BE OFFERED!**

### **RIBBONS & AWARDS**

**Ribbons or Rosettes are offered for BOB and all stake placements.**

BOB: Purple & Gold;

1<sup>st</sup>: Blue; 2<sup>nd</sup>: Red; 3<sup>rd</sup>: Yellow; 4<sup>th</sup>: White; NBQ: Green.

Breeder Stake and Kennel Stake: Dark Green.

High Scoring Singles: Navy & Gold.

- BOB: Hogan Leather Embellished Coursing Slip Offered by: Martin and Jennifer English, Tartan Farms Scottish Deerhounds;  
Robin Raab deerhound head plaque offered by: Debbie Habian, Eynhallow
- Field Champion Stake 1st - NBQ each a Hogan Leather padded coursing lead Offered by: Steve and Mary Chandler, Iron Thistle Deerhounds
- Open Stake 1st - NBQ, 1st Hogan Leather padded coursing lead, 2nd thru 5th Hogan Leather kennel lead Offered by: Nancy Szakacs and John Cordy  
Veteran Stake: 1st - NBQ each a Hogan Leather padded coursing lead
- Singles Stake: 1st - NBQ, 1st Hogan Leather padded coursing lead, 2nd thru 5th Hogan Leather kennel lead Offered by: Carmen and Mark Rasmussen, Glasdun
- Kennel Stake: Hogan Leather padded coursing slip.
- Breeder Stake: Hogan Leather padded coursing slip Offered by Bruach Deerhounds.

Unless otherwise noted, trophies are funded from the General Trophy Fund

#### CONDITIONS OF ENTRY

- Only pure bred Scottish Deerhounds one year of age or older on the day of the test/trial.
- Bitches in season and lame dogs will be excused. Entries will be refunded. **NO BITCHES IN SEASON ON THE FIELD!**
- Hounds lame at roll call will be excused with no refund given. However if you have another hound that can be substituted that will be allowed.
- Stakes will be split into flights by public random draw if the entry in any regular stake is 20 or more.
- Spayed, neutered, monorchid or cryptorchid hounds without breed disqualifications may be entered. Hounds with breed disqualifications are eligible to enter the Single Stake ONLY.
- All hounds will run twice, in trios if possible or braces (except in the Single Stake), unless excused, dismissed or disqualified.

**Scottish Deerhound Club of America  
Officers & Board**

President: Jana Brinlee  
 Vice Pres: Ann Hammond  
 Secretary: Laura Studer  
 Treasurer: Mark Rasmussen

**Judges:**

Debbie Narwold 65815 110th Street, McCalisburg, IA 50154  
 Frances Abrams 1899 Hilt Road, Yellowsprings, OH 45387

**QC's and JC's will be run on Tuesday following the  
 LGRA Meet, starting at 2:30pm ASFA Qualifying  
 runs will be run at this time, also.**

Field Trial Chairman	Debbie Habian 6720 Johnsburg Rd. Spring Grove, IL 60081
Field Trial Secretary	Judy Lowther ECES 4300 Denison Ave Cleveland, OH 44109 216-402-9022 • Pfyre@PfyreWhpts.com
Lure Operators	Joe Shoemaker
Field Clerks	Debbie Habian
Huntmasters	Brad Nelson
Inspection	Jane Brown, Kara Wattenbarger & Janice Parrow
Paddock	Kara Wattenbarger and Rich Paice
Equipment Crew	Brad Nelson and Rich Paice
Hospitality	Lynne Lozano

**VETERNARIAN  
 Frankenmuth-Birch Run Veterinary Hospital  
 9339 S Gera Road  
 Birch Run, MI 48415  
 989-652-6689**

- ⚡ A battery operated continuous loop lure machine will be used with highly visible plastic strip lure.
- ⚡ Course reversed for finals and run offs.
- ⚡ SDCA reserves the right to alter course due to weather or field conditions
- ⚡ Stakes will be split into flights by public random draw if entry in any regular stake is 20 or more.
- ⚡ Dogs not present at the ending time of roll call will be scratched and no refund will be given.
- ⚡ Only the Lure Operator, Huntmaster, Judge(s) and Handler of the dog running the the course in progress will be permitted near the lure machine.
- ⚡ BEST IN FIELD WILL NOT BE OFFERED

## **STAKES OFFERED AND RUNNING ORDER**

- **Open:**
- Scottish Deerhounds that have met certification requirements, excluding ASFA Field Champions of Record.
- **Field Champion:**
- Scottish Deerhounds that have earned their ASFA Field Championship titles.
- **Veteran:**
- Any eligible Scottish Deerhound that has met certification requirements and is 6 years of age or older.
- **Single:**
- Any eligible Scottish Deerhound including those disqualified to run in other stakes, and those with breed disqualifications. NOT ELIGIBLE TO RUN FOR BEST OF BRED.
- **Kennel:**
- Any two eligible Scottish Deerhounds designated at the time of entry in one of the regular stakes and owned by the same individual.
- **Breeder:**
- Any two eligible Scottish Deerhounds designated at the time of entry in one of the regular stakes and bred by the same individual.
- ASFA Certifications **s will be run on Tuesday, May 31 following the LGRA Meet, starting at 2:30 pm. Please arrange for a suitable hound to certify your deerhound with. Entry Fee \$20**
- **Those qualifying and wishing to run in the June 2nd trial must turn in entry paperwork prior to leaving the field on May 31st.**

**COURSE PLAN - Tuesday, May 31st for Cetrification Runs**

660 yards.....

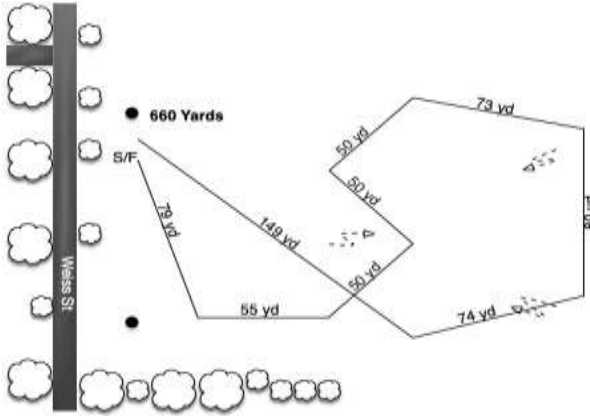

**ASFA COURSE PLAN - THURSDAY. JUNE 2ND**

890 Yards.....

The SDCA reserves the right to alter the course diagram as required by weather and/or field conditions on the day of the trial, included with the course plan.

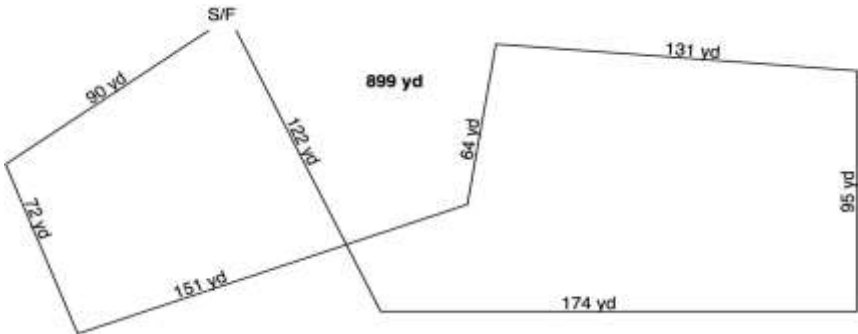

## **ELIGIBILITY & ADDITIONAL INFORMATION**

- Only pure bred Scottish Deerhounds one year of age or older on the day of the test/trial.
- ALL entries shall be individually registered with the AKC (ILP/PAL included), the UKC, the FCI, an ASFA-recognized foreign or ASFA Board approved registry or possess a CRN from the SPDBS. A photocopy of acceptable registry must be submitted with each hound's first ASFA field trial entry.
- Single stake can have breed disqualifications.
- Dogs not present at the ending time of roll call will be scratched and no refund will be given.
- Entries will be acknowledged by email IF you include a legible email address on your entry form.
- Bitches in season and lame dogs will be excused. Entries will be refunded. **NO BITCHES IN SEASON ON THE FIELD!**
- A list of all award donors will be printed in the catalog.
- Spayed and neutered dogs are eligible to participate. Monorchid and cryptorchid hounds are ineligible.
- There will be a minimum \$25 returned check charge.
- A \$5.00 fine will be assessed for any loose dog on the field that is not competing in the course in progress. • A \$5.00 fine will be assessed for any handler not cleaning up after their dog.
- A \$5.00 fine will be assessed for any handler not cleaning up after their dog.
- SDCA reserves the right to alter course due to field and/or weather conditions on the day of the trial.
- Any person may, upon reasonable complaint, be asked to leave the grounds by the Trial Committee.
- **Children MUST be under control of their parents or guardians at all times.**
- Only the Lure Operator, Huntmaster, Judge, and Handler of the dog running in the course in progress will be permitted near the lure machine.
- Dogs must be individually registered with AKC (including PAL/ILP) FCI or individually registered with an ASFA recognized or ASFA Board approved Registry. **REGISTRATIONS CANNOT BE PENDING.**
- There will be a \$25 minimum returned check charge, for any check returned by the bank.
- All hounds will run twice, in trios if possible or braces (except in the Single Stake), unless excused, dismissed or disqualified. **Please provide your own food, water, and shade (if appropriate) for handlers and hounds.**

## **HOST HOTEL**

### **Barvarian Inn Lodge & Conference Center**

1 Covered Bridge Lane Frankenmuth, MI 48734  
989-652-7200  
[www.bavarianInn.com](http://www.bavarianInn.com)

## **Other Local Lodging**

Holiday Inn Express & Suites, 926 South Main Street,  
Frankenmuth, MI 48734  
989-652-8100

Drury Inn and Suites, 260 South Main  
Frankenmuth, MI 48734  
989-652-2800

Frankenmuth Motel, 1218 Weiss Street  
Frankenmuth, MI 48734  
989-652-6171

## **RV CAMPING**

Jellystone Park 1339 Weiss Street  
Frankenmuth, MI 48734  
989-652-6668

Pine Ridge RV Campground 11700 Gera Road (M-83)  
Birch Run, MI 48415  
989-624-9029



**Official Entry Form**  
**AMERICAN SIGHTHOUND FIELD ASSOCIATION**  
**SCOTTISH DEERHOUND CLUB OF AMERICA**

**Wednesday, May 16, 2018**

Early entries close **at 7PM on Wednesday, May 18, 2022**  
at the FTS's residence.

Early entry fees: **\$25.00** Test entry fee: **\$20.00**

**Gate entry fee: \$30.00**

Make checks payable (IN US FUNDS) to "ECES".

Mail to "Judy Lowther; 4300 Denison Ave; Cleveland, OH 44109

Fee Paid \_\_\_\_\_ The Field Secretary cannot accept conditional, unsigned, incomplete or unpaid entries; please check your completed entry carefully.

Breed: <b>Scottish Deerhound</b>		Call Name:	
Registered Name of Hound:			
Stake: <input type="checkbox"/> Open <input type="checkbox"/> FCH <input type="checkbox"/> Veteran <input type="checkbox"/> Single <input type="checkbox"/> Limited		Additional Stakes <input type="checkbox"/> Kennel <input type="checkbox"/> Breeder <input type="checkbox"/> Bench	
Registration Number: (please write in registering body before number)			
<input type="checkbox"/> If possible, please separate my hounds	Date of Birth:	Sex: <input type="checkbox"/> Dog <input type="checkbox"/> Bitch	
Name of actual owner(s):			
Address:		Phone:	
City:		State:	Zip:
E-mail (Optional)		(Optional) Region of Residence:	
Emergency Contact Name and Phone (Optional)			
<b>Check if this is the first ASFA trial for this hound. Attach a Hound Certification or waiver if entered in Open, Veterans, Limited.</b>			
<b>Check if this is a first-time entry, a copy of the official Registration of this hound must accompany this entry unless NGA.</b>			
Check if any information has changed since the last ASFA trial entry. Regarding _____			
Check if this hound has been dismissed within the last 6 trials entered. Must be marked in order to qualify for a "clean" trial requirement.			

I CERTIFY that I am the actual owner of this dog, or that I am the duly authorized agent of the actual owner whose name I have entered above. In consideration of the acceptance of this entry and the opportunity to have this dog judged and to win prize money, ribbons, or trophies, I (we) agree to abide by the rules and regulations of the American Sighthound Field Association in effect at the time of this lure field trial, and by any additional rules and regulations appearing in the premium list for this lure field trial. I (we) agree that the club holding this lure field trial has the right to refuse this entry for cause, which the club shall deem to be sufficient. I (we) agree to hold this club, its members, directors, governors, officers, agents or other functionaries, any employees of the aforementioned parties and the owner(s) of the trial premises or grounds harmless from any claim for loss or injury which may be alleged to have been caused directly or indirectly to any person or thing by the act of this dog while in or upon the lure field trial premises or grounds or near any entrance thereto and I (we) personally assume all responsibility and liability for any such claim, and I (we) further agree to hold the aforementioned parties harmless from any claim loss of this dog by disappearance, theft damage or injury be caused or alleged to be caused by the negligence of the club or any of the aforementioned parties or by the negligence of any person or any other cause or causes. I (we) certify and represent that the dog entered is not a hazard to person or other dogs. This entry is submitted for acceptance of the foregoing representations and agreements.

SIGNATURE of owner or his agent Duly authorized to make this entry: \_\_\_\_\_

\_\_\_\_\_  
Please separate the entries before submitting to FTS.

Email Address: \_\_\_\_\_

**Official Entry Form**  
**AMERICAN SIGHTHOUND FIELD ASSOCIATION**  
**SCOTTISH DEERHOUND CLUB OF AMERICA**

**Wednesday, May 16, 2018**

Early entries close **at 7PM on Wednesday, May 18, 2022**  
at the FTS's residence.

Early entry fees: **\$25.00** Test entry fee: **\$20.00**

**Gate entry fee: \$30.00**

Make checks payable (IN US FUNDS) to "ECES".

Mail to "Judy Lowther; 4300 Denison Ave; Cleveland, OH 44109

Fee Paid \_\_\_\_\_ The Field Secretary cannot accept conditional, unsigned, incomplete or unpaid entries; please check your completed entry carefully.

Breed: <b>Scottish Deerhound</b>		Call Name:	
Registered Name of Hound:			
<b>Stake:</b> <input type="checkbox"/> Open <input type="checkbox"/> FCH <input type="checkbox"/> Veteran <input type="checkbox"/> Single <input type="checkbox"/> Limited		Additional Stakes <input type="checkbox"/> Kennel <input type="checkbox"/> Breeder <input type="checkbox"/> Bench	
<b>Registration Number:</b> (please write in registering body before number)			
<input type="checkbox"/> If possible, please separate my hounds		Date of Birth:	Sex: <input type="checkbox"/> Dog <input type="checkbox"/> Bitch
Name of actual owner(s):			
Address:		Phone:	
City:		State:	Zip:
E-mail (Optional)		(Optional) Region of Residence:	
Emergency Contact Name and Phone (Optional)			
<b>Check if this is the first ASFA trial for this hound. Attach a Hound Certification or waiver if entered in Open, Veterans, Limited.</b> <b>Check if this is a first-time entry, a copy of the official Registration of this hound must accompany this entry unless NGA.</b>			
Check if any information has changed since the last ASFA trial entry. Regarding _____			
Check if this hound has been dismissed within the last 6 trials entered. Must be marked in order to qualify for a "clean" trial requirement.			

I CERTIFY that I am the actual owner of this dog, or that I am the duly authorized agent of the actual owner whose name I have entered above. In consideration of the acceptance of this entry and the opportunity to have this dog judged and to win prize money, ribbons, or trophies, I (we) agree to abide by the rules and regulations of the American Sighthound Field Association in effect at the time of this lure field trial, and by any additional rules and regulations appearing in the premium list for this lure field trial. I (we) agree that the club holding this lure field trial has the right to refuse this entry for cause, which the club shall deem to be sufficient. I (we) agree to hold this club, its members, directors, governors, officers, agents or other functionaries, any employees of the aforementioned parties and the owner(s) of the trial premises or grounds harmless from any claim for loss or injury which may be alleged to have been caused directly or indirectly to any person or thing by the act of this dog while in or upon the lure field trial premises or grounds or near any entrance thereto and I (we) personally assume all responsibility and liability for any such claim, and I (we) further agree to hold the aforementioned parties harmless from any claim loss of this dog by disappearance, theft damage or injury be caused or alleged to be caused by the negligence of the club or any of the aforementioned parties or by the negligence of any person or any other cause or causes. I (we) certify and represent that the dog entered is not a hazard to person or other dogs. This entry is submitted for acceptance of the forgoing representations and agreements.

SIGNATURE of owner or his agent Duly authorized to make this entry: \_\_\_\_\_

\_\_\_\_\_  
Please separate the entries before submitting to FTS.

Email Address: \_\_\_\_\_

**Official Entry Form**  
**AMERICAN SIGHTHOUND FIELD ASSOCIATION**  
**SCOTTISH DEERHOUND CLUB OF AMERICA**

**Wednesday, May 16, 2018**

Early entries close **at 7PM on Wednesday, May 18, 2022**  
at the FTS's residence

Early entry fees: **\$25.00** Test entry fee: **\$20.00**

**Gate entry fee: \$30.00**

Make checks payable (IN US FUNDS) to "ECES".

Mail to "Judy Lowther; 4300 Denison Ave; Cleveland, OH 44109

Fee Paid \_\_\_\_\_ The Field Secretary cannot accept conditional, unsigned, incomplete or unpaid entries; please check your completed entry carefully.

Breed: <b>Scottish Deerhound</b>	Call Name:		
Registered Name of Hound:			
<b>Stake:</b> <input type="checkbox"/> Open <input type="checkbox"/> FCH <input type="checkbox"/> Veteran <input type="checkbox"/> Single <input type="checkbox"/> Limited		Additional Stakes <input type="checkbox"/> Kennel <input type="checkbox"/> Breeder <input type="checkbox"/> Bench	
<b>Registration Number:</b> (please write in registering body before number)			
<input type="checkbox"/> If possible, please separate my hounds	Date of Birth:	Sex: <input type="checkbox"/> Dog <input type="checkbox"/> Bitch	
Name of actual owner(s):			
Address:		Phone:	
City:		State:	Zip:
E-mail (Optional)		(Optional) Region of Residence:	
Emergency Contact Name and Phone (Optional)			
<b>Check if this is the first ASFA trial for this hound. Attach a Hound Certification or waiver if entered in Open, Veterans, Limited.</b> <b>Check if this is a first-time entry, a copy of the official Registration of this hound must accompany this entry unless NGA.</b>			
Check if any information has changed since the last ASFA trial entry. Regarding _____			
Check if this hound has been dismissed within the last 6 trials entered. Must be marked in order to qualify for a "clean" trial requirement.			

I CERTIFY that I am the actual owner of this dog, or that I am the duly authorized agent of the actual owner whose name I have entered above. In consideration of the acceptance of this entry and the opportunity to have this dog judged and to win prize money, ribbons, or trophies, I (we) agree to abide by the rules and regulations of the American Sighthound Field Association in effect at the time of this lure field trial, and by any additional rules and regulations appearing in the premium list for this lure field trial. I (we) agree that the club holding this lure field trial has the right to refuse this entry for cause, which the club shall deem to be sufficient. I (we) agree to hold this club, its members, directors, governors, officers, agents or other functionaries, any employees of the aforementioned parties and the owner(s) of the trial premises or grounds harmless from any claim for loss or injury which may be alleged to have been caused directly or indirectly to any person or thing by the act of this dog while in or upon the lure field trial premises or grounds or near any entrance thereto and I (we) personally assume all responsibility and liability for any such claim, and I (we) further agree to hold the aforementioned parties harmless from any claim loss of this dog by disappearance, theft damage or injury be caused or alleged to be caused by the negligence of the club or any of the aforementioned parties or by the negligence of any person or any other cause or causes. I (we) certify and represent that the dog entered is not a hazard to person or other dogs. This entry is submitted for acceptance of the forgoing representations and agreements.

SIGNATURE of owner or his agent Duly authorized to make this entry: \_\_\_\_\_

Please separate the entries before submitting to FTS.

Email Address: \_\_\_\_\_

**AMERICAN SIGHTHOUND FIELD ASSOCIATION  
HOUND CERTIFICATION**

**Rule effective October 1, 1994: Ch. V, Sec. 4 (a) OPEN STAKE:** *To be eligible to enter the open stake, a hound must have been certified by a licensed judge within the year preceding the closing date for the entry or have previously competed in the Open Stake.* This eligibility requirement also applies to a hound entered in the Limited or Veteran Stake, which has not competed in Open previously. Please complete this portion of this form and attach it to the entry form for the hound's first entry, including an entry for a Fun Trial.

Registered Name of Hound: \_\_\_\_\_

Registration Number: \_\_\_\_\_ Breed: \_\_\_\_\_

Registered Owner's Name: \_\_\_\_\_

I hereby certify that on (date) \_\_\_\_\_, the above named hound completed a lure course of at least 500 yards, running with another hound of the same breed (or another breed with a similar running style). During the course the above named hound showed no inclination to interfere with the other hound. I further certify that I am a licensed judge for the ASFA.

Name of Licensed Judge: \_\_\_\_\_

Signature: \_\_\_\_\_ Date: \_\_\_\_\_

I hereby certify that the hound running in the certification course is the hound identified above and that information provided on this form is true and correct.

Signature: \_\_\_\_\_ Date: \_\_\_\_\_

Owner or Authorized Agent of Hound

This certification form must be attached to the entry form the first time this hound is entered in an open, limited, or veteran stake. Any hound entered in open, limited, or veteran (as a first time entered hound), which has not been certified, shall be declared ineligible by the records coordinator and shall forfeit any points and placements awarded.

**PLEASE RETAIN A COPY FOR YOUR RECORDS.  
AMERICAN SIGHTHOUND FIELD ASSOCIATION  
HOUND CERTIFICATION WAIVER**

**Waiver of Requirement:** *This requirement will be waived for a hound that has earned a lure coursing or racing title from another recognized organization, if such title requires competition, and if a waiver for such title has been approved by the ASFA, or a CKC Hound Certification Form. If your hound qualifies for a waiver, complete this portion of this form and attach it to your entry form. Proof of waivers must accompany this certification form.*

Registered Name of Hound: \_\_\_\_\_

Registration Number: \_\_\_\_\_ Breed: \_\_\_\_\_

Registered Owner's Name: \_\_\_\_\_

**CKC:** FCH FCHX **CWA:** ARX TRP SRA DPC

**AKC:** QC SC FC **LGRA:** GRC **NAWRA:** RCH SR

**WRA:** CR WRCH **NOTRA:** ORC OTR SORC SOR

Hound Certification previously submitted.

I hereby certify that the hound identified above has completed the requirements for the title indicated above (or that the required Certification was previously submitted) and that the information provided on this form is true and correct.

Signature: \_\_\_\_\_ Date: \_\_\_\_\_

Owner or Authorized Agent of Hound